

## USB 3.0 Fingerprint Encrypted Drive Enclosure | For 2.5" SATA SSDs/HDDs

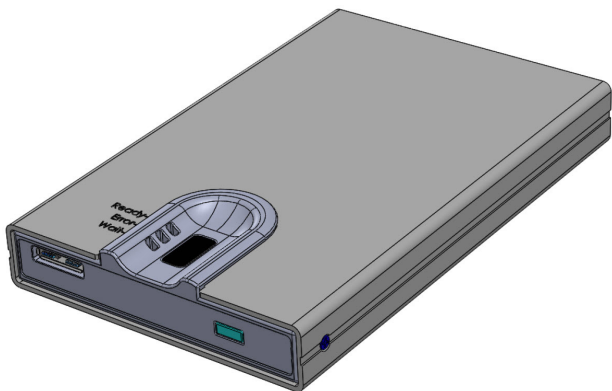

*Actual product may vary from photos*

### User Manual

SKU#: S251BMU3FP

For the latest information and specifications visit  
[www.startech.com/S251BMU3FP](http://www.startech.com/S251BMU3FP)

# Compliance Statements

## FCC Compliance Statement

This equipment has been tested and found to comply with the limits for a Class B digital device, pursuant to part 15 of the FCC Rules. These limits are designed to provide reasonable protection against harmful interference in a residential installation. This equipment generates, uses and can radiate radio frequency energy and, if not installed and used in accordance with the instructions, may cause harmful interference to radio communications. However, there is no guarantee that interference will not occur in a particular installation. If this equipment does cause harmful interference to radio or television reception, which can be determined by turning the equipment off and on, the user is encouraged to try to correct the interference by one or more of the following measures:

- Reorient or relocate the receiving antenna
- Increase the separation between the equipment and receiver
- Connect the equipment into an outlet on a circuit different from that to which the receiver is connected
- Consult the dealer or an experienced radio/TV technician for help

## Industry Canada Statement

This Class B digital apparatus complies with Canadian ICES-003.

Cet appareil numérique de la classe [B] est conforme à la norme NMB-003 du Canada.

CAN ICES-3 (B)/NMB-3(B)

## Use of Trademarks, Registered Trademarks, and other Protected Names and Symbols

This manual may make reference to trademarks, registered trademarks, and other protected names and/or symbols of third-party companies not related in any way to StarTech.com. Where they occur these references are for illustrative purposes only and do not represent an endorsement of a product or service by StarTech.com, or an endorsement of the product(s) to which this manual applies by the third-party company in question. Regardless of any direct acknowledgement elsewhere in the body of this document, StarTech.com hereby acknowledges that all trademarks, registered trademarks, service marks, and other protected names and/or symbols contained in this manual and related documents are the property of their respective holders.

# Safety Statements

## Safety Measures

- Wiring terminations should not be made with the product and/or electric lines under power.
- Cables (including power and charging cables) should be placed and routed to avoid creating electric, tripping or safety hazards.

## Mesures de sécurité

- Les terminaisons de câblage ne doivent pas être effectuées lorsque le produit et/ou les câbles électriques sont sous tension.
- Les câbles (y compris les câbles d'alimentation et de chargement) doivent être placés et acheminés de façon à éviter tout risque électrique, de chute ou de sécurité

## 安全対策

- 電源が入っている状態の製品または電線の終端処理を行わないでください。
- ケーブル(電源ケーブルと充電ケーブルを含む)は、適切な配置と引き回しを行い、電気障害やつまづきの危険性など、安全上のリスクを回避するようにしてください。

## Misure di sicurezza

- I terminali dei fili elettrici non devono essere realizzate con il prodotto e/o le linee elettriche sotto tensione.
- I cavi (inclusi i cavi di alimentazione e di ricarica) devono essere posizionati e stesi in modo da evitare pericoli di inciampo, rischi di scosse elettriche o pericoli per la sicurezza.

## Säkerhetsåtgärder

- Montering av kabelavslutningar får inte göras när produkten och/eller elledningarna är strömförda.
- Kablar (inklusive elkablar och laddningskablar) ska dras och placeras på så sätt att risk för snubblingsolyckor och andra olyckor kan undvikas.

# Table of Contents

<b>Compliance Statements</b> .....	<b>1</b>
<b>Safety Statements</b> .....	<b>2</b>
<b>Product Diagram</b> .....	<b>4</b>
Exterior View .....	4
Interior View .....	5
<b>Product Information</b> .....	<b>6</b>
Package Contents .....	6
Requirements .....	6
<b>Hardware Installation</b> .....	<b>7</b>
Installing a SATA Hard Drive .....	7
<b>Software Operation</b> .....	<b>11</b>
Navigation and Icons .....	11
<b>Formatting the Hard Drive</b> .....	<b>14</b>
Changing the Master Password .....	16
Fingerprint Setup .....	16
Renaming a Fingerprint Scan .....	18
Deleting a Fingerprint Scan .....	18
Forgetting the Current Password .....	19
<b>LED Indicators</b> .....	<b>19</b>

# Product Diagram

## Exterior View

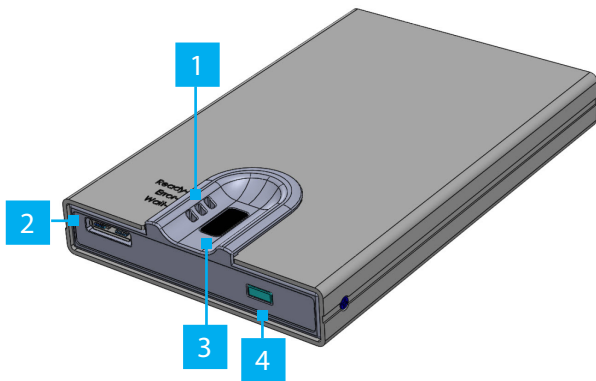

<b>1</b>	<b><i>LED Indicators (Ready, Error, and Wait)</i></b>
<b>2</b>	<b><i>USB Micro-B Port</i></b>
<b>3</b>	<b><i>Fingerprint Pad</i></b>
<b>4</b>	<b><i>Disk Access LED</i></b>

## Interior View

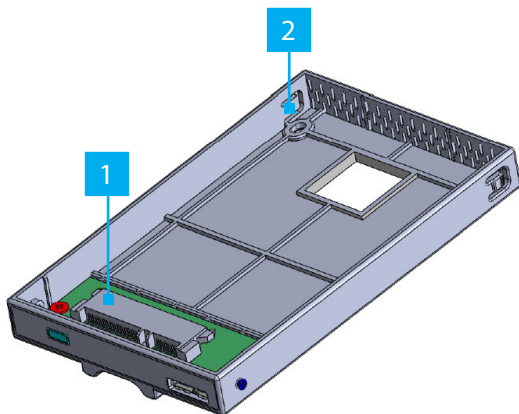

<b>1</b>	<b><i>SATA Hard Drive Connector</i></b>
<b>2</b>	<b><i>Hard Drive Mounting Screw Holes (x 2)</i></b>

## Product Information

### Package Contents

- USB 3.0 Fingerprint Encrypted Drive Enclosure x 1
- 50 cm USB-C to USB Micro-B Cable x 1
- 50 cm USB-A to USB Micro-B Cable x 1
- Micro Screw Driver x 1
- Installation Screw Kit x 1
- User Manual x 1

### Requirements

- 2.5" SATA SSD or HDD
- Host Computer with either a USB-C or USB-A port
- Default Password = startech

## Hardware Installation

### Installing a SATA Hard Drive

1. Using the **Micro Screwdriver** (included), remove the two **Enclosure Screws** from each of the sides on the **Drive Enclosure**.

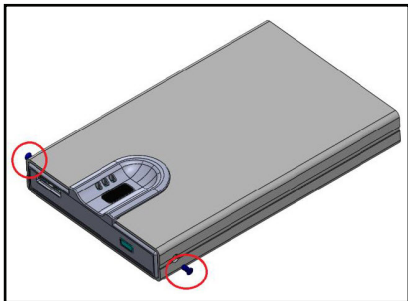

*Removing the Enclosure Screws*

2. Slide the **Drive Slot** from the **Drive Enclosure**.



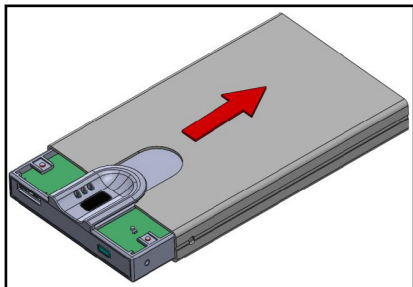

*Removing the Drive Slot*

3. Flip the **Drive Slot** over, to expose the **SATA Hard Drive Connector**.

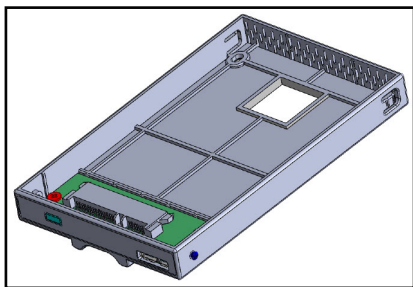

*Flip over the Drive Slot*

4. On a 30° angle, slide the **Hard Drive** into the **SATA Hard Drive Connector**.

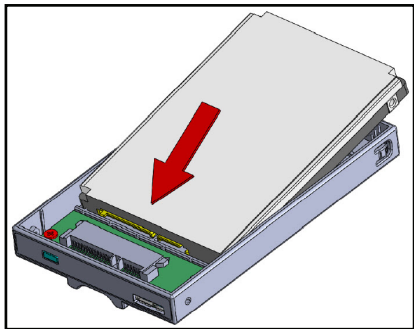

*Inserting the Hard Drive*

5. Gently push down on the **Hard Drive** securing it into the **SATA Hard Drive Connector**.
6. Flip the **Drive Slot** over and insert two **Hard Drive Mounting Screws** into the two **Hard Drive Mounting Holes**.

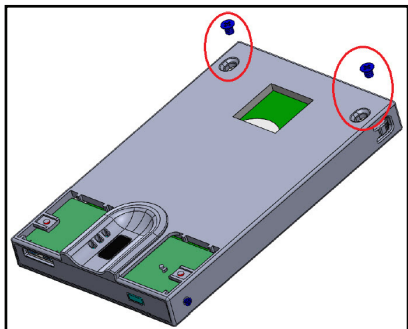

### *Installing the Hard Drive Screws*

7. Using the **Micro Screwdriver** tighten the **Hard Drive Mounting Screws**, securing the **Hard Drive** in place. Be careful not to over-tighten the **Hard Drive Mounting Screws**.
8. Slide the **Drive Slot** back into the **Drive Enclosure**, making sure to align the **Fingerprint Pad** with the **Fingerprint Pad Cutout**.
9. Insert the **Enclosure Screws** into the side of the **Drive Enclosure**.
10. Using the **Micro Screwdriver** tighten the **Enclosure Screws**. Be careful not to over-tighten the **Enclosure Screws**.





11. Connect the **USB Micro-B to USB Cable** (the other end will depend on the USB port on the **Host Computer**) to the **USB Micro-B Port** on the **Drive Enclosure** and to a USB port on the **Host Computer**.

## Software Operation

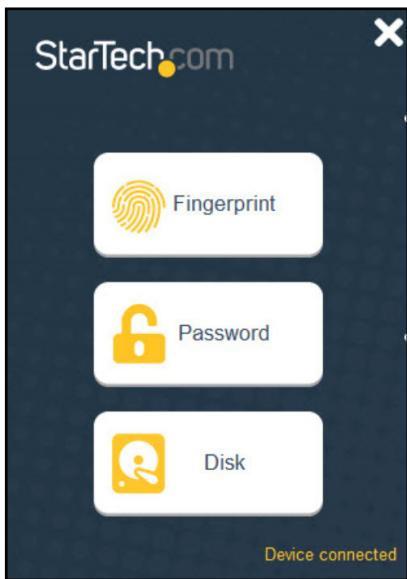
### Navigation and Icons

#### FTP Tool Home Screen



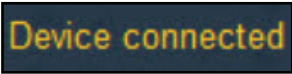

Screen Element	Description
	<ul style="list-style-type: none"> <li>Located in the top right-hand corner of the screen. Closes the <b>FTP Tool</b>.</li> </ul>
	<ul style="list-style-type: none"> <li>Opens the <b>Fingerprint Management</b> screen, where you can create, rename, and delete fingerprints.</li> </ul>
	<ul style="list-style-type: none"> <li>Opens the <b>Password Management</b> screen, where you can change the default master password.</li> </ul>
	<ul style="list-style-type: none"> <li>Allows you to reset the connected <b>Hard Drive</b> to default factory settings.</li> </ul>
	<ul style="list-style-type: none"> <li>Shows that a <b>Hard Drive</b> is correctly connected to the <b>Drive Enclosure</b>.</li> </ul>

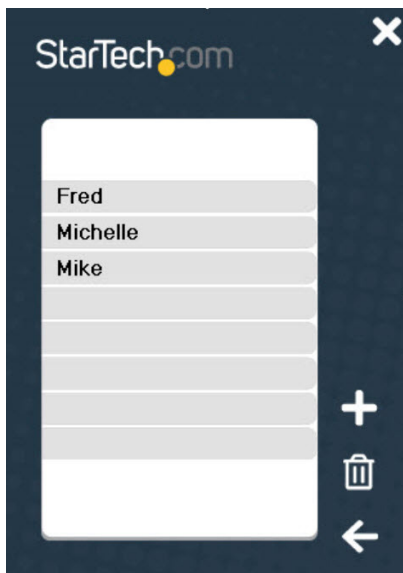
## Fingerprint Management Screen



Screen Element	Description
	<ul style="list-style-type: none"><li>• Allows you to add/create a new fingerprint scan.</li></ul>

	<ul style="list-style-type: none"><li>• Deletes the select fingerprint scan from the <b>Drive Enclosure</b>.</li></ul>
	<ul style="list-style-type: none"><li>• Returns to the previous screen.</li></ul>

## Formatting the Hard Drive

Before formatting the **Hard Drive** you must first install the **Hard Drive** into the **Drive Enclosure**. See [Installing a SATA Hard Drive](#) section for instructions.

1. Connect the **USB Micro-B to USB Cable** (the other end will depend on the USB port on the **Host Computer**) to the **USB Micro-B Port** on the **Drive Enclosure** and to a USB port on the **Host Computer**.
2. On the **Host Computer's Operating System**, navigate to the **File Explorer** screen.
3. Click **BD-ROM Drive FTP Tool**, from the list.
4. Click **FTP Tool** from the list, to connect to the **Drive Enclosure**.
5. The **FTP Tool Home** screen will appear.
6. Click on the **Disk** Button.
7. Click the **Restore to the Factory Default Settings** button.

8. A confirmation screen will appear, indicating that all data on the **Hard Drive** will be erased when restoring to factory defaults.
9. Click the **OK** button to reset the **Hard Drive** to factory defaults.
10. When the **Hard Drive** is reset to factory default another confirmation screen will appear indicating that the **Hard Drive** is now reformatted.

**Note:** During the process a pop-up window might appear stating you need to reformat the disk before you can use it, click the **Cancel** button to continue the process.

11. Click the **OK** button to return to the previous screen.
12. Click the **Unlock the Disk** button.
13. Enter the **Administrator Password**. If you have not previously changed the password, the default password is **startech**.
14. Click the **OK** button.
15. A confirmation screen will appear when the secured partition is opened.
16. Click the **OK** button. When you navigate back to the **File Explorer** screen, you will see two drive listings, one will be the emulated drive **BD-ROM Drive FTP Tool** and one will be the new blank drive.



## Changing the Master Password

1. From the **FTP Tool Home** screen, click on the **Password** button.
2. The **Password Management** screen will appear.
3. Enter the current administrator password in the **Previous Administrator Password** field.
4. Enter the new password in the **New Administrator Password** field. The password is alphanumeric and must be a minimum of 6 to a maximum of 16 characters in length.
5. Enter the new password for a second time in the **Confirm the Administrator Password** field.
6. Click the **OK** button, a confirmation screen will appear confirming that the new password was successfully set.

## Fingerprint Setup

You can store up to eight fingerprint scans within the **Drive Enclosure**. The **Drive Enclosure** and **Drive** make a pairing so you cannot use the stored prints for other drives nor move the drive to another enclosure and access the prints.

1. From the **FTP Tool Home** screen, click on the **Fingerprint** button.
2. The **Password** screen will appear.
3. Enter the **Administrator Password** and click the **OK** button. If you have not previously changed the password, the default password is **startech**.
4. The **Fingerprint Management** screen will appear.

5. Click the **Create a New Fingerprint** button.
6. The **Wait LED** will begin to flash blue on the **Drive Enclosure**.
7. Place your finger on the **Fingerprint Pad** and wait for the **Recording Process** to begin. Lift your finger on and off of the **Fingerprint Pad** repositioning your finger each time, until the recording process percentage reaches 100%. If the **Error LED** flashes red this indicates an error has occurred during the scanning process or that the scan and storage was incomplete. Reposition your finger on the **Fingerprint Pad** until the **Ready LED** flashes green. The **Ready LED** indicates a valid fingerprint scan and you will also see the recording process percentage increase.

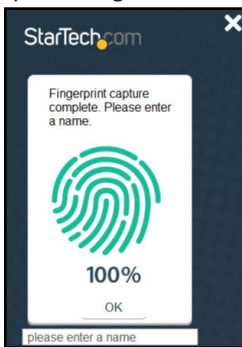

### *Completed Fingerprint Scan*

8. When the **Recording Process** reaches 100% click the **OK** button to register the fingerprint.

9. When the scan is complete the user must name the stored fingerprint and the click **OK** button.

## Renaming a Fingerprint Scan

1. From the **FTP Tool Home** screen, click on the **Fingerprint** button.
2. The **Password** screen will appear.
3. Enter the **Administrator Password** and click the **OK** button. If you have not previously changed the password, the default password is **startech**.
4. The **Fingerprint Management** screen will appear, listing any registered fingerprint scans.
5. Double click the stored fingerprint to edit the name. Names must be alphanumeric and between 1-28 characters in length.

## Deleting a Fingerprint Scan

1. From the **FTP Tool Home** screen, click on the **Fingerprint** button.
2. The **Password** screen will appear.
3. Enter the **Administrator Password** and click the **OK** button. If you have not previously changed the password, the default password is **startech**.
4. The **Fingerprint Management** screen will appear, listing any registered fingerprint scans.
5. Click on the fingerprint from the list you want to delete.

6. Click the **Delete** (trash can) button.
7. Click **OK** on the confirmation screen.

## Forgetting the Current Password

If you forget the administrator password you can reset the administrator password back to the default password (startech).

**Caution:** *When resetting the administrator password all data on the connected **Hard Drive** will also be erased.*

1. From the **FTP Tool Home** screen, click on the **Fingerprint Management** button.
2. The **Password** screen will appear.
3. Enter the **Administrator Password** and click the **OK** button. If you have not previously changed the password, the default password is **startech**.
4. The **Fingerprint Management** screen will appear.
5. Click the **Forget password** link.
6. A confirmation screen will appear stating that if you run the forget password function that all data will be erased off of the connected **Hard Drive** and the **Drive Enclosure** will be reset to factory defaults.
7. Click the **OK** button to complete the process.

## LED Indicators

There are three **LED Indicators** on the top of the **Drive Enclosure Ready, Error, and Wait**. The Following table describes the function of each **LED Indicator**.

<i>LED Indicator</i>	<i>Function</i>
<i>Ready</i>	<ul style="list-style-type: none"><li>Flashes Green: Indicates a valid fingerprint scan and Increases the recording process percentage.</li></ul>
<i>Error</i>	<ul style="list-style-type: none"><li>Flashes Red: This indicates an error has occurred during the scanning process or that the scan and storage was incomplete.</li></ul>
<i>Wait</i>	<ul style="list-style-type: none"><li>Flashes Blue: Indicates that the fingerprint pad is ready to scan a fingerprint.</li></ul>

## Warranty Information

This product is backed by a two-year warranty.

For further information on product warranty terms and conditions, please refer to [www.startech.com/warranty](http://www.startech.com/warranty).

## Limitation of Liability

In no event shall the liability of StarTech.com Ltd. and StarTech.com USA LLP (or their officers, directors, employees or agents) for any damages (whether direct or indirect, special, punitive, incidental, consequential, or otherwise), loss of profits, loss of business, or any pecuniary loss, arising out of or related to the use of the product exceed the actual price paid for the product.

Some states do not allow the exclusion or limitation of incidental or consequential damages. If such laws apply, the limitations or exclusions contained in this statement may not apply to you.

## Hard-to-find made easy. At StarTech.com, that isn't a slogan. It's a promise.

StarTech.com is your one-stop source for every connectivity part you need. From the latest technology to legacy products — and all the parts that bridge the old and new — we can help you find the parts that connect your solutions.

We make it easy to locate the parts, and we quickly deliver them wherever they need to go. Just talk to one of our tech advisors or visit our website. You'll be connected to the products you need in no time.

Visit [www.startech.com](http://www.startech.com) for complete information on all StarTech.com products and to access exclusive resources and time-saving tools.

StarTech.com is an ISO 9001 Registered manufacturer of connectivity and technology parts. StarTech.com was founded in 1985 and has operations in the United States, Canada, the United Kingdom and Taiwan servicing a worldwide market.

### Reviews

Share your experiences using StarTech.com products, including product applications and setup, what you love about the products, and areas for improvement.

#### StarTech.com Ltd.

45 Artisans Cres.  
London, Ontario  
N5V 5E9  
Canada

FR: [startech.com/fr](http://startech.com/fr)  
DE: [startech.com/de](http://startech.com/de)

#### StarTech.com LLP

2500 Creekside Pkwy.  
Lockbourne, Ohio  
43137  
U.S.A.

ES: [startech.com/es](http://startech.com/es)  
NL: [startech.com/nl](http://startech.com/nl)

#### StarTech.com Ltd.

Unit B, Pinnacle  
15 Gowerton Rd.,  
Brackmills  
Northampton  
NN4 7BW  
United Kingdom

IT: [startech.com/it](http://startech.com/it)  
JP: [startech.com/jp](http://startech.com/jp)